

LOW VOLTAGE ELECTRONIC TRANSFORMER

MODEL EN-12100-R-AR

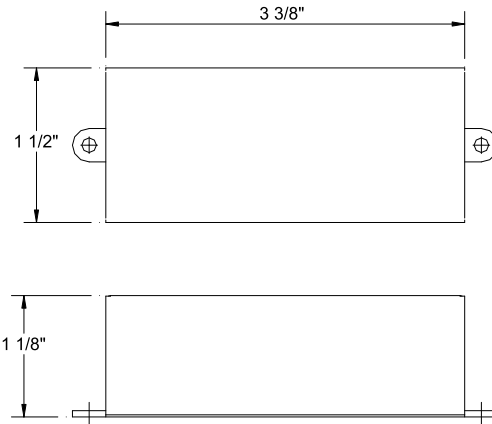

Ordering Matrix

Model	Finish	Accessories
EN-12100-R-AR	Black	See table below

Ordering Example (*model*) : EN-12100-R-AR

Product Details

Description:	Low Voltage electronic transformer designed to be used as a replacement part for factory installed transformers. Transformer may be safely loaded to 100% of stated capacity.
Catalog Number:	EN = Advanced electronic circuitry 12100 = 12volt , 100watt R = Replacement AR = Auto-Reset
Input:	120V (50/60Hz)
Output:	12V
Min Load:	35W
Max Load:	100W
Max Input Amp:	0.83A (@ 120V)
Transformer Frequency:	20khz. True RMS meter is required to read the high frequency output.
Listing:	U.L. recognized component part, File Number E204239.
Accessories:	ETB – Enclosure and connection box MTB-01 – Terminal Block

Specification Features

- U.L. 2108 listed electronic low voltage transformer.
- Built-in auto reset, soft start, short and overload circuit protection features. Soft start delayed start feature extends lamp life.
- Dimmable with electronic low voltage dimmers. Dimmers should always be installed on the primary side of the transformer.
- In the case of a system overload or short circuit the transformer will revert to a "hold" position and then automatically reset the system when the problem is solved. System protection is designed to last several hours.
- 5 year WAC Lighting product warranty.

LOW VOLTAGE ELECTRONIC TRANSFORMER

MODEL EN-12150-R-AR

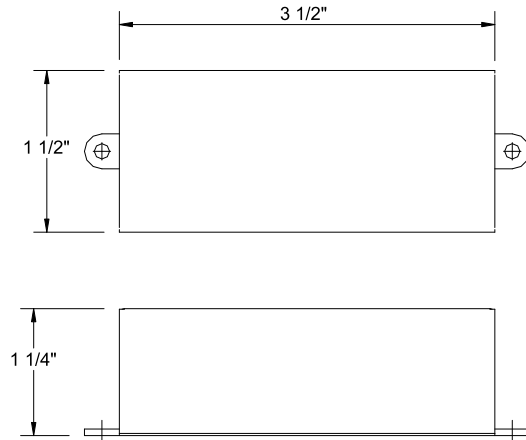

Ordering Matrix

Model	Finish	Accessories
EN-12150-R-AR	Black	See table below

Ordering Example (model) : EN-12150-R-AR

Product Details

Description:	Low Voltage electronic transformer designed to be used as a replacement part for factory installed transformers. Transformer may be safely loaded to 100% of stated capacity.
Catalog Number:	EN = Electronic 12150 = 12volt , 150watt R = Replacement AR = Auto-Reset
Input:	120V (50/60Hz)
Output:	12V
Min Load:	50W
Max Load:	150W
Max Input Amp:	1.25A (@ 120V)
Transformer Frequency:	20khz. True RMS meter is required to read the high frequency output.
Listing:	U.L. recognized component part, File Number E204239.
Accessories:	METB – Enclosure and connection box MTB-01 – Terminal Block

Specification Features

- U.L. 2108 listed electronic low voltage transformer.
- Built-in auto reset, soft start, short and overload circuit protection features. Soft start delayed start feature extends lamp life.
- Dimmable with electronic low voltage dimmers. Dimmers should always be installed on the primary side of the transformer.
- In the case of a system overload or short circuit the transformer will revert to a "hold" position and then automatically reset the system when the problem is solved. System protection is designed to last several hours.
- 5 year W.A.C. Lighting product warranty.

LOW VOLTAGE ELECTRONIC TRANSFORMER

MODEL EN-24150-R-AR

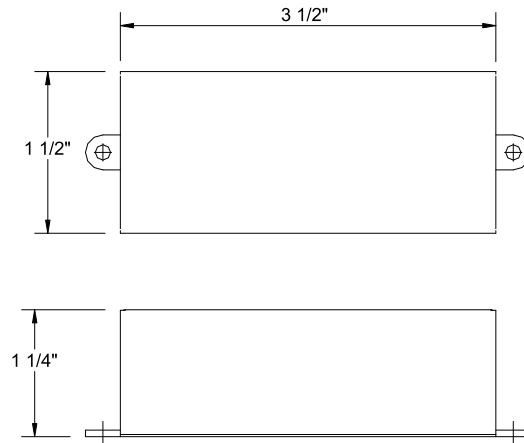

Ordering Matrix

Model	Finish	Accessories
EN-24150-R-AR	Black	See table below

Ordering Example (model) : EN-24150-R-AR

Product Details

Description:	Low Voltage electronic transformer designed to be used as a replacement part for factory installed transformers. Transformer may be safely loaded to 100% of stated capacity.
Catalog Number:	EN = Advanced electronic circuitry 24150 = 24 volt , 150 watt R = Replacement AR = Auto-Reset
Input:	120V (50/60Hz)
Output:	24V
Min Load:	50W
Max Load:	150W
Max Input Amp:	1.25A (@ 120V)
Transformer Frequency:	20 khz. True RMS meter is required to read the high frequency output.
Listing:	U.L. recognized component part, File Number E204239.
Accessories:	METB – Enclosure and connection box MTB-01 – Terminal Block

Specification Features

- U.L. 2108 listed electronic low voltage transformer.
- Built-in auto reset, soft start, short and overload circuit protection features. Soft start delayed start feature extends lamp life.
- Dimmable with electronic low voltage dimmers. Dimmers should always be installed on the primary side of the transformer.
- In the case of a system overload or short circuit the transformer will revert to a “hold” position and then automatically reset the system when the problem is solved. System protection is designed to last several hours.
- 5 year W.A.C. Lighting product warranty.