



North American Headquarters
 601 Rayovac Drive
 Madison, WI 53711
 Telephone 1-800-331-4522
 Internet www.rayovac.com

Marketing Data Sheet - Batteries

S6600177
 Issue S
 Memo No: 21740

Rayovac Stock Number: **AL-C Battery**

Name: **AL-C Alkaline**

Engineering Parameters:

Cell Chemistry:

Alkaline Manganese Dioxide

Designation:

ANSI/NEDA – 14A (AA), IEC – LR14

Nominal Voltage:

1.5 volts

Approximate Weight:

2.5 Oz (70 grams)

Approximate Volume:

1.6 CU IN (26 cc)

Operating Temp. Range:

-30° C to 55° C (-20° F to 130° F)

Terminals: Flashlight

Shell: Plastic

Environmental:

Meets Environmental Protection Agency (EPA)

Requirements For Landfill Disposal.

No Mercury Added Formulation

[Rayovac Alkaline Material Data Safety Sheets](#)

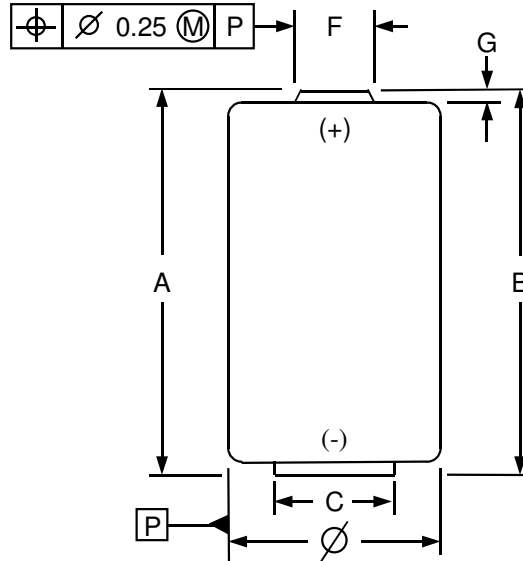

Dimensions	Millimeters	Inches
A (Max)	50.0	1.969
B (Min)	48.5	1.909
C (Min)	13.0	0.512
E (Max)	0.9	0.035
F (Max)	7.5	0.295
G (Min)	1.5	0.059
Ø (Max)	26.2	1.031
Ø (Min)	24.9	0.980

Service life guidelines and representative discharge curves are shown on the following page.

Typical Initial Service Life

Application and Duty Cycle	Discharge Load	Midpoint Current mA	Cut-off Voltage	Service	Units	Discharge Capacity (mAh)
Lighting 4 min/hr, 8hr/day	3.9 Ω	300	0.9	21.4	hours	6410
Lighting, Continuous burn	3.9 Ω	300	0.9	17.7	hours	5450
Toy 1 hr/day	3.9 Ω	293	0.8	22.5	hours	6696
Portable Stereo 2 hrs/day	400 mA	400	0.9	13.6	hours	5440
Radio 4 hrs/day	20 Ω	125	0.9	118	hours	7316

Typical Discharge Characteristics at 21C (70F)

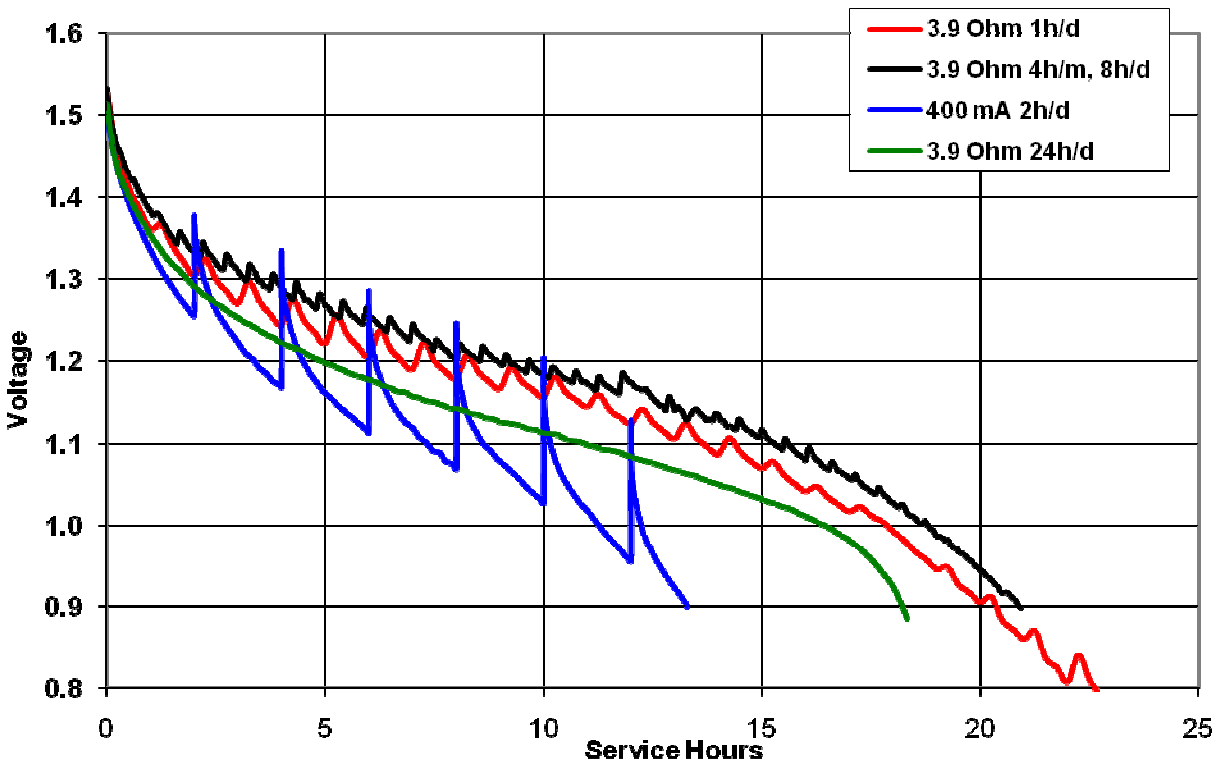

Typical Discharge Characteristics at 21C (70F) - Radio Application

