

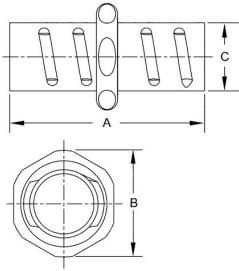

**FLEXIBLE METAL SCREW-IN AND SET-SCREW TYPE CONNECTORS AND COUPLINGS**

Screw-In Couplings Die Cast Zinc  
N/A

B65



Catalog #: 2273

**APPLICATIONS**

For use in dry locations to bond flexible metal conduit to a box or enclosure  
N/A

**PRODUCT FEATURES**

Rugged metallic construction insures mechanical protection for the raceway

**UL LISTED**

Standard 514B, UL Listed E195969

**CSA**

C22.2 No. 18

**GENERAL PRODUCT INFORMATION**

Trade Size: 3/4 in.

**DRAWING DIMENSIONS**

Dimension A: 2-7/64 in.  
Dimension B: 1-7/32 in.  
Dimension C: 53/64 in.

**PACKAGING**

Package Type: Carton  
Std. Pkg.: 25  
Ship Carton Qty.: 250  
Product UPC-A Labeled: No  
Weight (Lbs. Per/C): 8.30  
Ship Carton Length (in.): 18.89  
Ship Carton Width (in.): 10.59  
Ship Carton Height (in.): 6.81  
Ctn Weight (Lbs.): 20.75  
UPC Number: 050169022733  
I2of5: 50050169022738