



High Output T12

F96T12/CW/HO-O ALTO 15PK

Philips T12 fluorescent lamps provide high performance in a wide range of sizes, shapes, and types.

Product data

General Information	
Cap-Base	R17D [R17d (RDC)]
Life 3-Hr Start [Hrs]	12000 h
Features	ALTO® (ALTO)
Footnotes Fluorescent/CFL 1	Meets the National Energy Policy Act of 1992 exemption for outdoor or cold temperature applications only. (223)

Light Technical	
Color Code	33
Initial lumen (Nom)	8800 lm
Color Designation	Cool White (CW)
Design Mean Lumens	7650 lm
Correlated Color Temperature (Nom)	4100 K
Color Rendering Index (Nom)	62

Operating and Electrical	
Power (Rated) (Nom)	110 W

Mechanical and Housing	
Cap-Base Information	Green Base
Nominal Length (Inch)	96

Approval and Application	
Energy Saving Product	Not Applicable
Mercury (Hg) Content (Nom)	6.8 mg

Product Data	
Order product name	TL F96T12/CW/HO-O ALTO 110W FLUOR. LAMP
EAN/UPC - Product	046677381769
Order code	381764
Numerator - Quantity Per Pack	1
Numerator - Packs per outer box	15
Material Nr. (12NC)	927895203323
Net Weight (Piece)	0.001 kg

Warnings and Safety

- Lamp contains mercury. Manage in Accord with Disposal Laws. See: www.lamprecycle.org or 1-800-555-0050

High Output T12

Dimensional drawing

Product

TL F96T12/CW/HO-O ALTO 110W FLUOR. LAMP

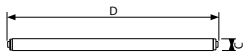

T12 Revised Double Contact

F96T12 110W/33 HO ALTO

