

**READ AND FOLLOW ALL SAFETY INSTRUCTIONS!
SAVE THESE INSTRUCTIONS AND DELIVER TO OWNER AFTER INSTALLATION**

IMPORTANT SAFETY INSTRUCTIONS

▲WARNING

To reduce the risk of death, injury or property damage from fire, electric shock, cuts, abrasions, falling parts, and other hazards:

- Service of the equipment must be performed by qualified service personnel.
- Installation and maintenance must be performed by a person familiar with the construction and operation of this product and any hazards involved. All applicable codes and ordinances must be followed.
- Read this document before installing, servicing, or maintaining this equipment or installing a lamp. These instructions do not cover all installation, service, and maintenance situations. If your situation is not covered, or if you do not understand these instructions or additional information is required, contact *Lithonia Lighting* or your local *Lithonia Lighting* Distributor.
- Read and follow all warnings and instructions provided by the lamp manufacturer.

▲WARNING

Before installing, servicing, or maintaining this equipment, follow these general precautions.

To reduce the risk of electrocution:

- Make sure the equipment is properly grounded.
- Always de-energize the circuit and/or equipment before connecting to, disconnecting from, or servicing the equipment.

To reduce the risk of fire:

- Keep material away that can burn from hot lamp.
- Make sure lamps are correctly installed.
- Use supply conductors with a minimum installation temperature rating as specified on equipment.

To reduce the risk of personal injury from cuts, abrasions, or falling parts:

- Wear gloves to prevent cuts or abrasions from sharp edges when removing from carton, handling and maintaining this equipment.
- Do not use abrasive materials, glass cleaners or other solvents on reflector or lens. These substances may damage equipment and cause parts to eventually break and fall.
- Do not install a damaged fixture.

▲CAUTION: Observe lamp manufacturer's recommendations and restrictions on lamp operation, including but not limited to ballast type, burning position, replacement and cycling. Use only lamps that comply with applicable ANSI standards.

NOTICE: If lamp is marked  it contains mercury. Follow disposal laws. See www.lamprecycle.org

Lithonia Lighting, a division of *Acuity Brands Lighting*, Inc., assumes no responsibility for claims arising out of improper or careless installation or handling of this product.

SAVE THESE INSTRUCTIONS

Installation Instructions TFA Accessories

Delivery: Upon receipt of fixture and accessories (packed separately), thoroughly inspect for any freight damage. All damage should be reported to the delivery carrier. Compare the catalog description listed on the packing slip with the fixture label on the inside of the housing to be sure you have received the correct merchandise.

TFAWG Wire Guard

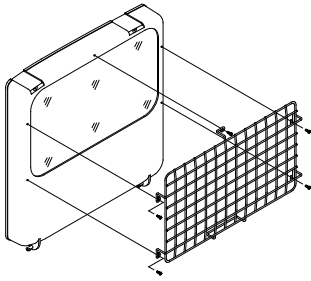

Wire Guard: Attach with (5) five 8-32 x 1/2" screws into pre-drilled holes. If holes are not pre-drilled, open bezel, place wire guard against bezel and align wire guard with mounting hole to indicator pilot bosses. Mark correct bosses to be drilled. Remove wire guard. Drill the marked indicator pilot bosses with 5/32" bit. Place wireguard against outer surface and mount as noted above.

Vandal Guard: Attach 2 top L-shaped mounting brackets to the top of the guard and the 2 remaining L-shaped brackets to the bottom of the guard using the (4) screws and nuts provided. Drill cast front cover in the four (4) locations shown with indicators (.140 dia. - 9/64")

TFAVG Polycarbonate Vandal Guard

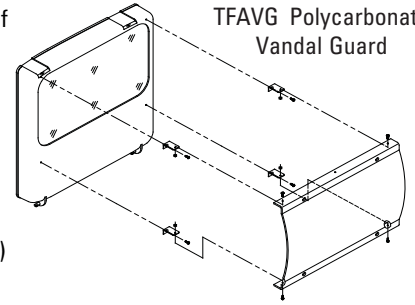

TFAFV Full Visor

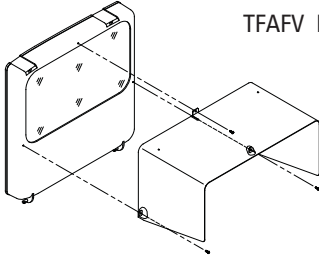

TFAUV Upper Visor

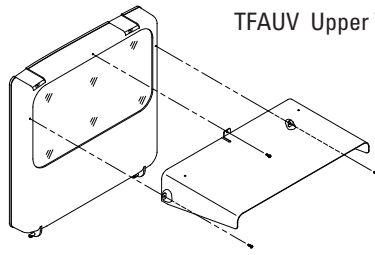

TFABV Bottom Visor

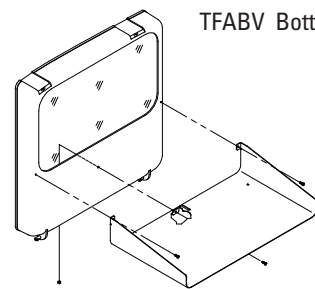

Full, Upper, and Bottom Visor 1. Attach the visor to the doorframe using (3) screws provided.

If your TFA did not come factory drilled, drill .140 diameter (9/64") holes. The inside of the front cover has locator holes to aid in drilling.

NOTE: When using the upper visor or full visor with a vandal or wire guard, you must: 1) Attach visor first, then place guard on fixture; and 2) Use closing screws that are included in hardware bag.

VG w/FV

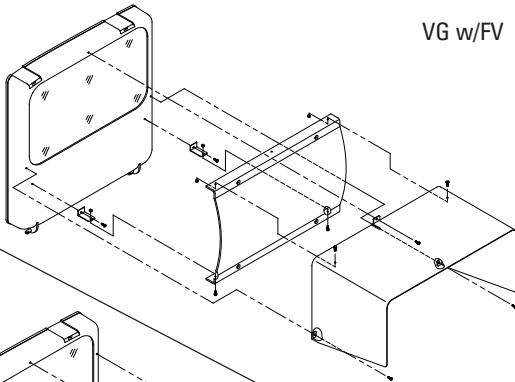

WG w/FV

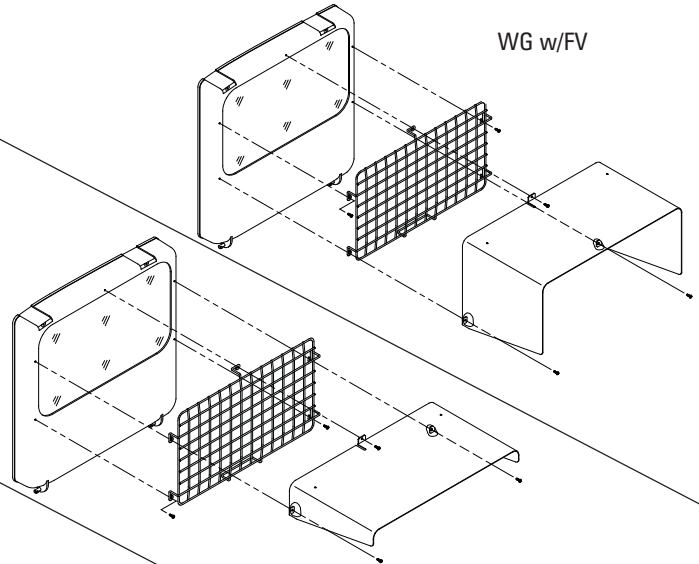

VG w/UV

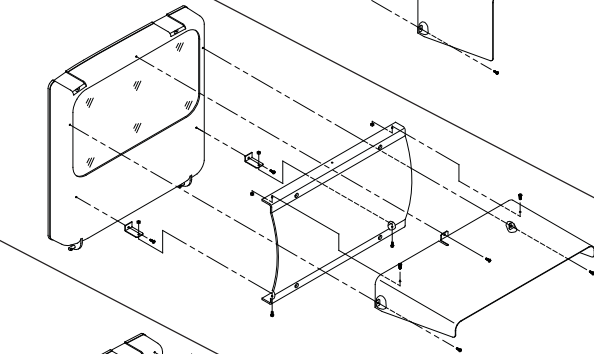

WG w/UV

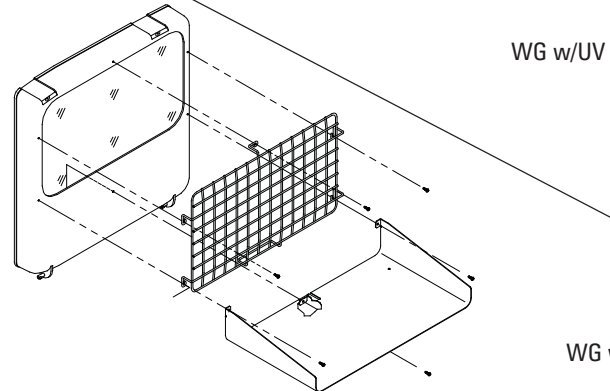

VG w/BV

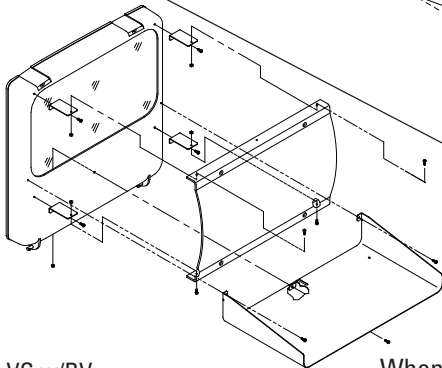

WG w/BV

When using the bottom visor with a vandal or wire guard, you must attach the guard first as shown.



An Acuity Brands Company

©2001 Acuity Brands Lighting, Inc. All Rights Reserved. Rev. 05/10

Lithonia Lighting Outdoor
One Lithonia Way, Conyers, GA 30012
Phone: 800-279-8041 Fax: 770-918-1209
www.lithonia.com

Part Number: RJ52100163 Rev C
Revision Date: 11/4/10