

FEATURES & SPECIFICATIONS

INTENDED USE

Ideal for a wide variety of low- to medium-height ceiling applications including commercial, retail and hospital-ity spaces where a wallwash fixture is required.

OPTICAL SYSTEM

Aluminum full reflectors are optically designed to maximize lumen output and to provide superior glare control. Anodized finishes for wallwash reflectors are semi-specular or diffuse in a variety of colors. Polyester powder coat finishes also are available in white.

Wallwash reflector intended to direct light with a horizontal component to increase light intensity on walls, as well as provide downward light on horizontal surfaces. Kicker must face wall to be illuminated.

MECHANICAL SYSTEM

Heavy gauge die formed galvanized steel mounting frame with mechanical trim retention (yoke) ensures secure and flush reflector mounting to ceiling. Attached to frame are vertically adjustable mounting brackets for use with C channels, ½" steel conduit or 16 gauge flat bar hangers included, standard. Frames equipped with galvanized junction box UL Listed for through wire applications. Junction boxes equipped with (2) ¾" and (4) ½" conduit knockouts with pryout slots and removable access doors.

Retaining clips packed with reflector for installation on rough-in.

Maximum 1-1/2" ceiling thickness.

ELECTRICAL SYSTEM

Electronic ballast with end of lamp life protection standard. Class P thermally protected ballast protects against improper contact with insulation. Minimum starting temperature is 0°F/-18°C.

Rated for #12 AWG conductor thru-branch wiring. Minimum 90° supply wire. Ground wire provided.

Lamp Socket Base:

DTT 4-pin lamps – 18W (G24Q-2); 26W (G24Q-3)

TRT 4-pin lamps – 18W (GX24Q-2); 26W (GX24Q-3); 32W (GX24Q-3); 42W (GX24Q-4)

LISTING

Fixtures are UL Listed for thru-branch wiring, Non-IC recessed mounting, damp location, and to U.S. and Canadian Safety Standards.

WARRANTY — 1-year limited warranty. Complete warranty terms located at

www.acuitybrands.com/CustomerResources/Terms_and_conditions.aspx

NOTE: Actual performance may differ as a result of end-user environment and application.

Specifications subject to change without notice.

Catalog Number
Notes
Type

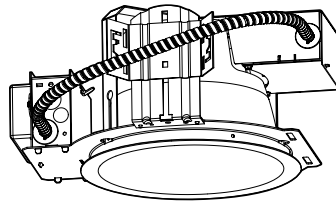

Compact Fluorescent Downlighting

6" LF6N

WALLWASH Horizontal 1-Lamp, Triple Tube (TRT)

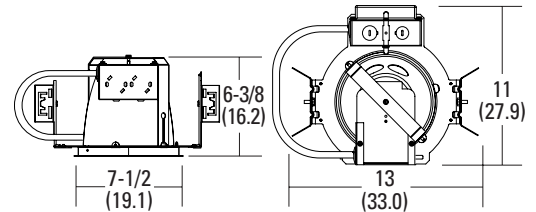

Specifications

Max. Height: 6-3/8 (16.2)

Ceiling Opening: 7 (17.8)

Overlap Trim: 7-1/2 (19.1)

Length: 13 (33.0)

Width: 11 (27.9)

All dimensions are inches (centimeters).

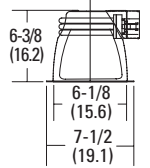

ORDERING INFORMATION

For shortest lead times, configure products using **bolded options**.

Example: LF6N 1/26-42TRT F6W4A MVOLT

LF6N					
Serie	Wattage/Lamp	Reflector/color	Voltage	Options ⁴	
LF6N	1/18DTT	F6W4	White wallwash	MVOLT² 120 277 347 ³	ADEZ Advance Mark 10 [®] electronic dimming ballast, 120V or 277V. Must be voltage specific. Minimum dimming level 5% ADZT Advance Mark 7 [®] electronic 0-10V DC dimming ballast. (120V-277V only.) ECOS Lutron EcoSystem electronic dimming ballast, 120V - 277V. Must be wattage specific. Minimum dimming level 5% EL Emergency PSDL3 DL battery pack with integral test switch ⁵ ELR Emergency PSDL3 DL battery pack with remote test switch ⁵ ELHL Iota I-420-R High lumen output emergency battery pack. Internal test switch provided. Maximum average lumen output is 1300 (42W) ⁶ ELRHL Iota I-420-EM-B High lumen output emergency battery pack. Remote test switch provided. Maximum average lumen output is 1300 (42W) ⁶ GMF Single slow-blow fuse, must specify voltage BDP Ballast disconnect plug (meets codes that require in-fixture disconnect) ³ RIF1 Radio interference filter LBH Less barhangers WLP 35K lamp (shipped separately) TRW White flange
	1/26DTT	F6W4A	Clear diffuse wallwash		
	1/18TRT	F6W4AZ	Clear semi-specular wallwash		
	1/26-42TRT¹	F6W4G	Gold diffuse wallwash		
	1/26TRT	F6W4GZ	Gold semi-specular wallwash		
	1/32TRT	F6W4PR	Pewter diffuse wallwash		
	1/42TRT	F6W4WTZ	Wheat semi-specular wallwash		

Accessories: Order as separate catalog number.	
SCA6	Sloped ceiling adaptor. Degree of slope must be specified (10D, 15D, 20D, 25D, 30D) Ex: SCA6 10D .
NPP16 D	nLight [®] network relay pack with 0-10V dimming. Refer to TN-602 . Fixtures must be ordered with ADZT option.
NPP16 D ER	nLight [®] network relay pack with 0-10V dimming for emergency circuit operation. Refer to TN-602 . Fixtures must be ordered with ADZT option. ⁷

NOTES:

- Not available with ECOS or WLP.
- Electronic multi-volt ballast capable of operating any line voltage from 120-277V, 50 or 60Hz.
- Not available with EL or ELR.
- For additional options see www.lithonia.com.
- Add 3" (7.6) to width and 4-1/2" (11.4) to length.
- Not recommended for field installation.
- For use with generator supply EM power. Will require an emergency hot feed and normal hot feed.

6" LF6N Horizontal 1-Lamp, Triple Tube (TRT), Wallwash

LF6N 1/32TRT MVOLT F6W4A, (1) 32W TRT lamp, 1.37 s/mh, 2400 rated lumens, test number LTL18340

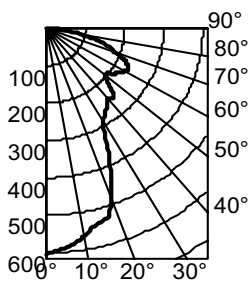

Intensity Distribution	
Vertical Angle	Horizontal Angle
0°	605
5°	589
15°	536
25°	379
35°	266
45°	238
55°	211
65°	229
75°	143
85°	39
90°	0

Zonal Lumen Summary		
Zone	Lumens	% Lamp
0° - 30°	490.7	20.4
0° - 40°	783.1	32.6
0° - 60°	1258.4	52.4
0° - 90°	1424.7	59.4
90° - 180°	23.0	1.0
0° - 180°	1447.7	*60.3
*Total Efficiency		

RCR	pf	Coefficients of Utilization					
		80%		70%		50%	
		50%	30%	50%	30%	50%	30%
0	72	72	70	70	66	66	
1	64	62	62	60	60	58	
2	57	53	55	52	53	50	
3	51	46	50	46	48	44	
4	45	41	45	40	43	39	
5	41	36	40	36	39	35	
6	37	32	37	32	35	31	
7	34	29	33	29	32	28	
8	31	26	31	26	30	26	
9	29	24	28	24	28	23	
10	26	22	26	22	26	22	

LF6N 1/32TRT MVOLT F6W4AZ, (1) 32W TRT lamp, 1.33 s/mh, 2400 rated lumens, test number LTL18337

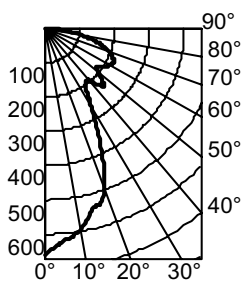

Intensity Distribution	
Vertical Angle	Horizontal Angle
0°	660
5°	622
15°	541
25°	380
35°	204
45°	240
55°	192
65°	217
75°	157
85°	59
90°	7

Zonal Lumen Summary		
Zone	Lumens	% Lamp
0° - 30°	503.1	21.0
0° - 40°	797.8	33.2
0° - 60°	1304.7	54.4
0° - 90°	1482.5	61.8
90° - 180°	23.0	1.0
0° - 180°	1505.4	*62.7
*Total Efficiency		

RCR	pf	Coefficients of Utilization					
		80%		70%		50%	
		50%	30%	50%	30%	50%	30%
0	74	74	73	73	69	69	
1	66	64	65	62	62	60	
2	59	55	58	54	55	52	
3	52	48	51	47	49	46	
4	47	42	46	42	45	41	
5	43	37	42	37	40	36	
6	39	33	38	33	37	32	
7	35	30	35	30	34	29	
8	32	27	32	27	31	27	
9	30	25	29	25	29	24	
10	28	23	27	23	27	22	