

FEATURES & SPECIFICATIONS

INTENDED USE — Ideal for a wide variety of low- to medium-height ceiling applications including commercial, retail and hospitality spaces where a baffled fixture is required.

CONSTRUCTION — Utilizes an extruded socket housing that attaches to the reflector via key hole mount, which provides superior heat dissipation and extended lamp life. Socket housing also adjusts to accommodate varying lamp lengths.

Heavy-gauge, die-formed galvanized steel mounting frame. Attached to frame are vertically adjustable mounting brackets for use with C channels, ½" steel conduit or 16-gauge flat bar hangers included, standard. Frames are equipped with galvanized junction box UL Listed for through-wire applications. Junction boxes equipped with (2) ¾" and (4) ½" conduit knockouts with pryout slots and removable access doors.

Reflector clips packed with reflector for installation on rough-in.

Maximum 1-1/2" ceiling thickness.

OPTICS — Aluminum full reflectors are optically designed to maximize lumen output and to provide superior glare control. The black or white baffled reflectors have a semi-specular upper finish with white painted flange standard.

ELECTRICAL — Electronic ballast with end of lamp life protection standard. Class P thermally protected ballast protects against improper contact with insulation. Minimum starting temperature is 0°F-18°C. Rated for #12 AWG conductor thru-branch wiring. Minimum 90° supply wire. Ground wire provided.

Lamp Socket Base:

DTT 4-pin lamps – 13W (G24Q-1); 18W (G24Q-2); 26W (G24Q-3)

TRT 4-pin lamps – 13W (GX24Q-1); 18W (GX24Q-2); 26W & 32W (GX24Q-3); 42W (GX24Q-4)

LISTINGS — Fixtures are UL Listed for thru-branch wiring, Non-IC recessed mounting, damp location, and to U.S. and Canadian Safety Standards.

WARRANTY — 1-year limited warranty. Complete warranty terms located at www.acuitybrands.com/CustomerResources/Terms_and_conditions.aspx

Note: Specifications subject to change without notice.

| |
|----------------|
| Catalog Number |
| Notes |
| Type |

Compact Fluorescent Downlighting

6" LP6FN



BAFFLE

Vertical 1-Lamp, Double Twin-Tube (DTT) or Triple-Tube (TRT)

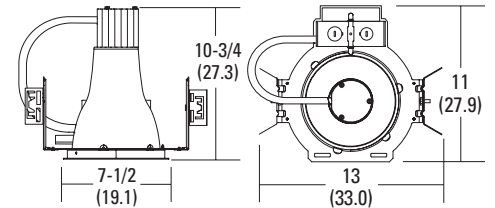

Specifications

Max. height: 10-3/4 (27.3)

Ceiling opening: 7 (17.8)

Overlap trim: 7-1/2 (19.1)

Length: 13 (33.0)

Width: 11 (27.9)

All dimensions are inches (centimeters) unless otherwise indicated.

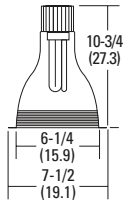

ORDERING INFORMATION For shortest lead times, configure product using **bolded options**.

Example: LP6FN 26-42TRT 6B9 MVOLT

| LP6FN Series | Wattage/Lamp | Reflector/Color ³ | Voltage | Options ⁶ |
|--------------|-----------------------------|---|--|--|
| LP6FN | 13DTT ¹ | 6B9 Black baffle 6B9W White baffle | MVOLT⁴ 120 277 347 ⁵ | ADEZ Advance Mark 10™ electronic dimming ballast, 120V or 277V. Musts be voltage specific. Minimum dimming level 5% |
| | 18DTT | | | ECOS Lutron EcoSystem electronic dimming ballast, 120V - 277V. Must be wattage specific. Minimum dimming level 5% |
| | 26DTT | | | EL Emergency PSDL3 DL battery pack with integral test switch ⁷ |
| | 13TRT ¹ | | | ELR Emergency PSDL3 DL battery pack with remote test switch ⁷ |
| | 18TRT | | | ELHL Iota I-420-R High lumen output emergency battery pack. Internal test switch provided. Maximum average lumen output is 1300 (42W) ⁸ |
| | 26-42TRT² | | | ELRHL Iota I-420-EM-B High lumen output emergency battery pack. Remote test switch provided. Maximum average lumen output is 1300 (42W) ⁸ |
| | 26TRT | | | GMF Single slow-blow fuse, must specify voltage |
| | 32TRT | | | BDP Ballast disconnect plug (meets codes that require in-fixture disconnect) ⁵ |
| | 42TRT | | | RIF1 Radio interference filter |
| | | | | |
| | | | | WLP 35K lamp (shipped separately) |

| | |
|---|---|
| Accessories: Order as separate catalog number. | |
| SCA6 | Sloped ceiling adaptor. Degree of slope must be specified (10D, 15D, 20D, 25D, 30D) Ex: SCA6 10D . |
| CTE6 | Ceiling thickness extender is used when ceiling thickness is greater than 1-1/2 (3.8). Maximum thickness 2 (5.1). |

Notes

- 1 Not available with ADEZ or ECOS.
- 2 Not available with ECOS or WLP.
- 3 White painted flange standard.
- 4 Electronic multi-volt ballast capable of operating any line voltage from 120-277V, 50 or 60Hz.
- 5 Not available with EL or ELR.
- 6 For additional options see www.lithonia.com.
- 7 Add 3" (7.6) to width and 4-1/2" (11.4) to length.
- 8 Not recommended for field installation.

6" LP6FN Vertical 1-Lamp, Double Twin-Tube (DTT) or Triple Tube (TRT), Baffle

PHOTOMETRICS

| Distribution Curve | Distribution Data | Output Data | Coefficient of Utilization | Illuminance Data at 30" Above Floor for a Single Luminaire |
|--------------------|-------------------|-------------|----------------------------|--|
|--------------------|-------------------|-------------|----------------------------|--|

LP6FN 1/26TRT 6B9 MVOLT, (1) 26W TRT lamp, 1800 rated lumens, 1.0 s/mh, Test no. LTL10754

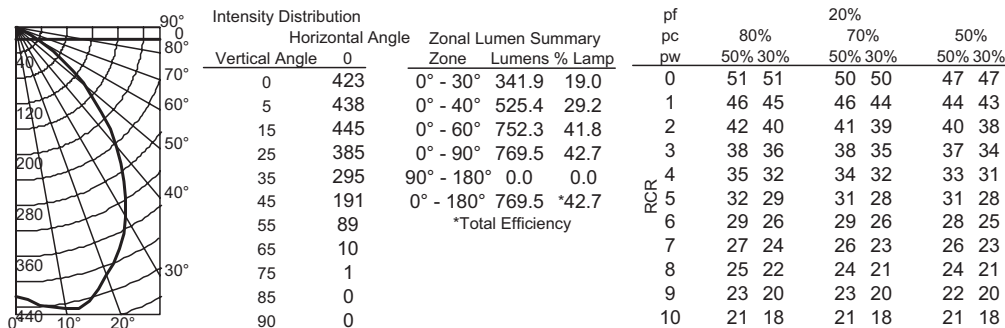

LP6FN 1/32TRT 6B9 MVOLT, (1) 32W TRT lamp, 2400 rated lumens, 1.0 s/mh, Test no. LTL10731

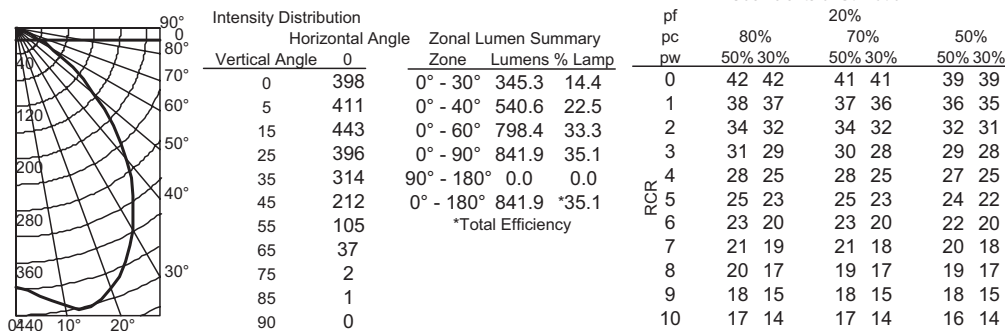

LP6FN 1/42TRT 6B9 MVOLT, (1) 42W TRT lamp, 3200 rated lumens, 1.1 s/mh, Test no. LTL10719

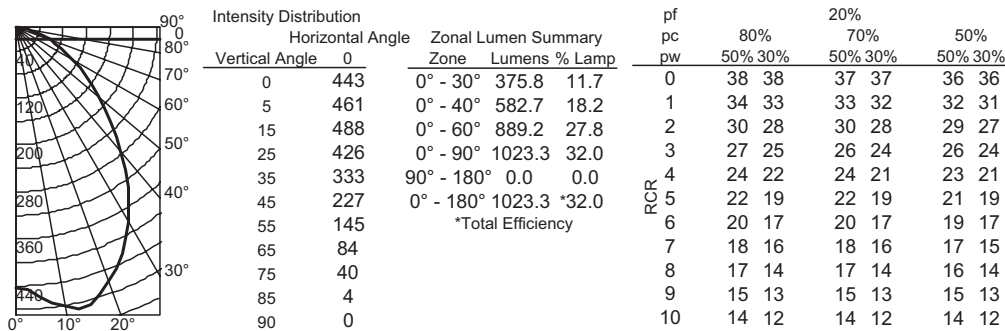

Notes

Actual performance may differ as a result of end-user environment and application.