

OVERVIEW

The Brighton DigitalSwitch is a 100% digital switch which may be programmed to control any relay, dimmer or SmartBreaker panel. Connected to any GR 2400 system via Cat. 5 patch cable with RJ45 connectors, Brighton DigitalSwitches can be mounted in any standard 2.25" deep switch box and uses decorator style switch plates.

Brighton DigitalSwitches can be ordered with 2, 4, 5, 6, 7 or 8 buttons per gang. Optional custom button engraving is available. Switches can be ordered pre-programmed or may be programmed in the field using the DTC (Digital Time Clock) or with GX2 lighting control software.

FEATURES

- Custom engraved buttons are available and can be ordered separately
- Pilot light illuminates all push buttons
- Optional factory preprogramming available

SPECIFICATIONS

Electrical

Power Supply: Powered by GR2400 bus
 Network Connection: Two RJ45 connectors
 Network Termination: Manual via jumper
 Switch Dimensions
 Switch: 1.7" W x 4.17" H x 1.82" D

Mechanical

Switch Plate - Decorator style
 Mounts in 2.25" deep-switch box
 Two RJ45 connectors

Environmental

Ambient: 32°F to 104°F (0°C to 40°C)
 Relative Humidity: 10 - 90% non-condensing

Warranty

Three-year limited warranty. Complete warranty terms located at:
www.acuitybrands.com/CustomerResources/Terms_and_conditions.aspx

Note: Actual performance may differ as a result of end-user environment and application. Specifications subject to change without notice.

Addresses

Addresses per switch: 1
 Switch addresses available: 1- 119 (max. slider switches in a bus is 16)

Functionality

Function: ON, OFF, Mixed, Group Control, Toggle, Scene Control

Programming

Via Digital Time Clock (DTC) or with GX2 lighting control software

AcuityControls™

LC&D™

GR 2400™
 Brighton



ORDERING INFORMATION

BRIGHTON DIGITALSWITCH

Example: BR5 BWH PWH

Series, # of buttons	Plate Color ¹
BR2 2 Buttons	BWH PWH White buttons and plate
BR4 4 Buttons	BIV PIV Ivory buttons and plate
BR5 5 Buttons	BAL PAL Almond buttons and plate
BR6 6 Buttons	BGY PGY Gray buttons and plate
BR7 7 Buttons	
BR8 8 Buttons	

Notes:

1. Button and plate colors can only be ordered in the combinations shown, they cannot be mixed.

SWITCH CONFIGURATIONS

Brighton DigitalSwitches are available in 2, 4, 5, 6, 7 and 8 buttons.

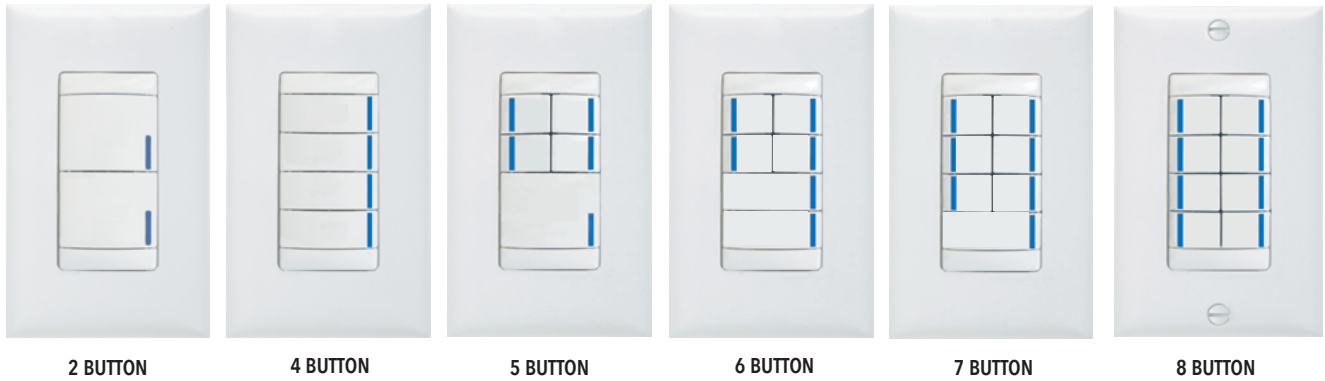

Note: Acuity Brands does not provide the cover plate. Cover plate is provided by contractor.

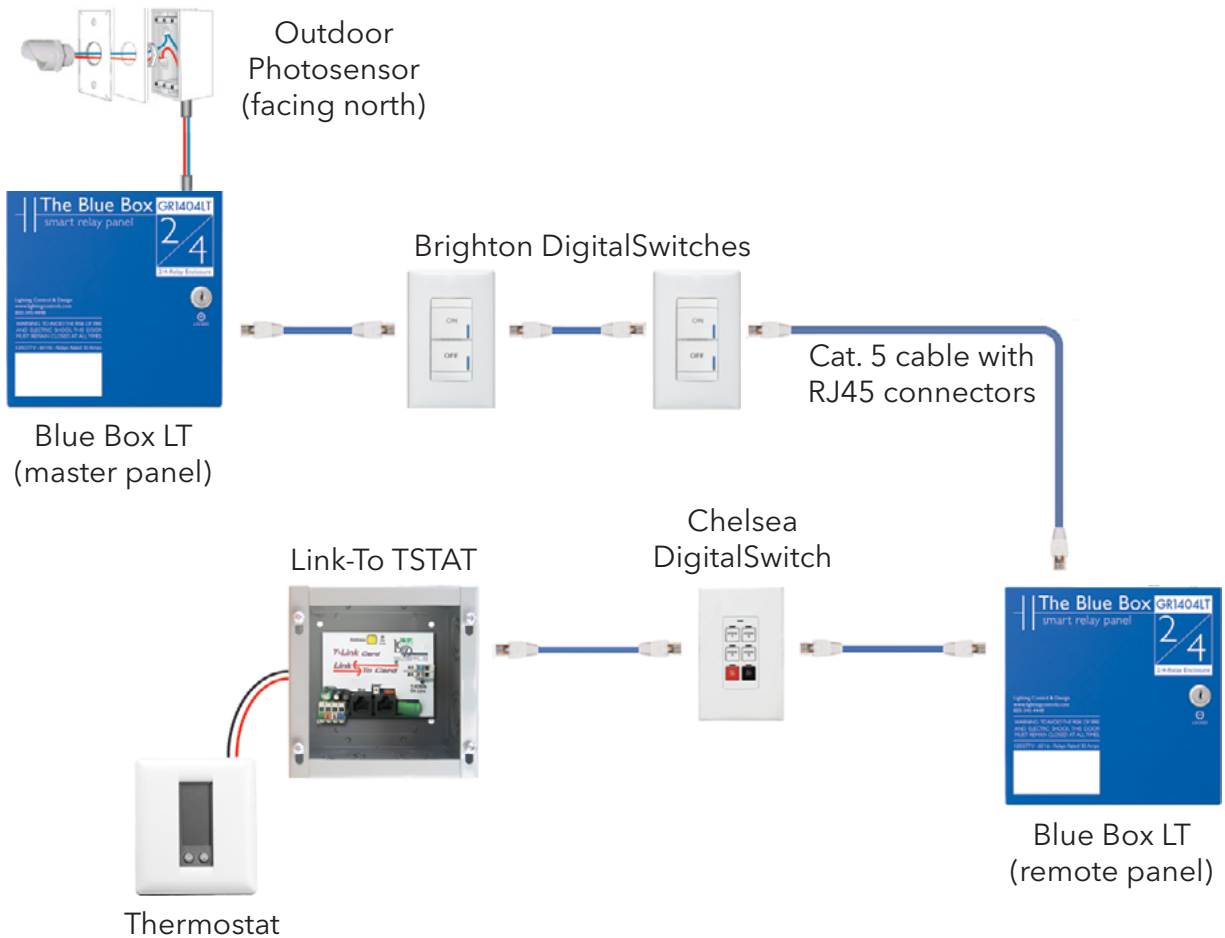

Title 24 System Component