

INSTRUCTIONS

For Assembling and Installing Fixtures in Canada
Pour L'assemblage et L'installation Au Canada

KICHLER® LED UNDERCABINET MOUNT POWER SUPPLY INSTALLATION INSTRUCTIONS P/N: 12353BK, 12353WH

NOTE: All installations should comply with national and local electrical codes. If you have any doubts concerning installation contact a qualified licensed electrician.

IMPORTANT SAFETY INSTRUCTIONS

- Read all instructions.
- Do not conceal or extend exposed conductors through a building wall.
- Do not install this system in wet locations.
- For low voltage exposed insulated conductor systems required by 30.1(c) do not install any part of this system less than 7 feet (2.2 m) above the floor.
- To reduce the risk of fire and burns, do not install this lighting system where the exposed bare conductors can be shorted or contact any conductive materials.
- To reduce the risk of fire and overheating, make sure all connections are tight.
- Do not install any luminaire closer than 6 inches (15.25 cm) from any curtain, or similar combustible materials.
- Turn off electrical power before modifying the lighting system in any way.

SAVE THESE INSTRUCTIONS

- On the tall side of wire module there are two gates. Feed a minimum of 4" (10.2 cm) of Type NM non-metallic sheathed cable (12-2 with ground or 14-2 with ground) through the gate. Trim cable to 4" (10.2 cm) if necessary.

NOTE: These gates serve as strain reliefs holding cable securely in place. Gates should not be removed and no more than one cable should pass through each.

- Peel back and remove outer jacket on cable to approximately ½" (1.3 cm) of inside of gate. (See Fig. 1)
- Strip approximately ½" (1.3 cm) of insulation off each black and white wire.

NOTE: On inside of wire module cover is a gage to assist in stripping the correct amount of insulation. (See Fig. 2)

- Position the housing against the back of the cabinet and fasten the housing to the mounting surface using the captive screws. (See Fig. 3 and 4)

NOTE: DO NOT OVER TIGHTEN SCREW.

- Use pliers to push stripped wires into the appropriate connectors. Careful not to cut insulation. (See Fig. 5)

NOTE: The push-in connectors are surrounded by color coded rings, indicating which wire to install.

- black wire to black ring connector
- white wire to white ring connector

NOTE: To remove the wires from the connectors, trim wires close to connector. Grip the trimmed stub with pliers and twist while pulling out ward.

- Push the un-insulated ground wire(s) into the provided, loose splicing connector. (See Fig. 5)
- Slightly tug on each wire to ensure connection has been made and is secure.

- Install wire module cover over exposed wires by aligning the front tabs with the slots in the housing and snapping cover into place. Firmly fasten the cover to the housing by using the included screw. (See Fig. 6)

NOTE: DO NOT OVER TIGHTEN SCREW.

- At this time proceed to LED fixture installation following instructions provided with fixture.

- To remove cover, remove center screw then slide screwdriver into slot formed by cover and wire module then pull screw driver handle away from wire module until cover separates from module.

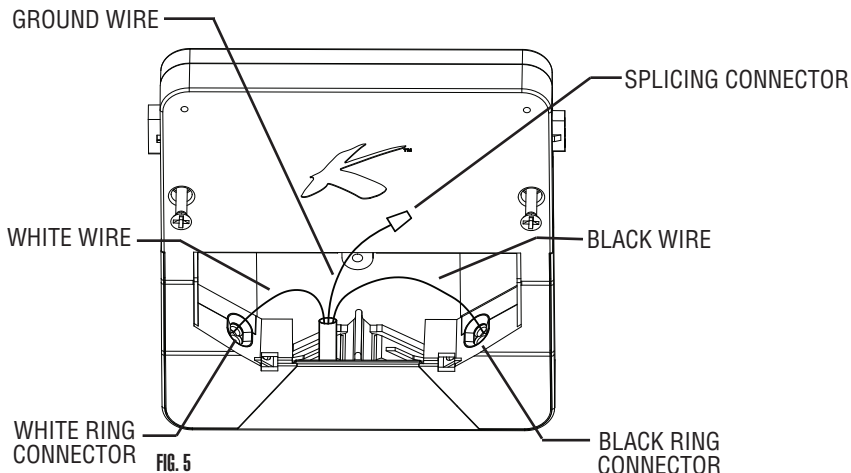

KICHLER

LIGHTING

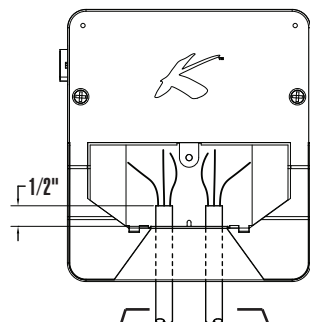

FIG. 1

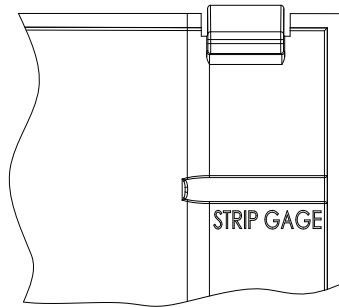

FIG. 2

FROM SWITCH OR
MAIN BREAKER

TO NEXT RUN OR
CABINET

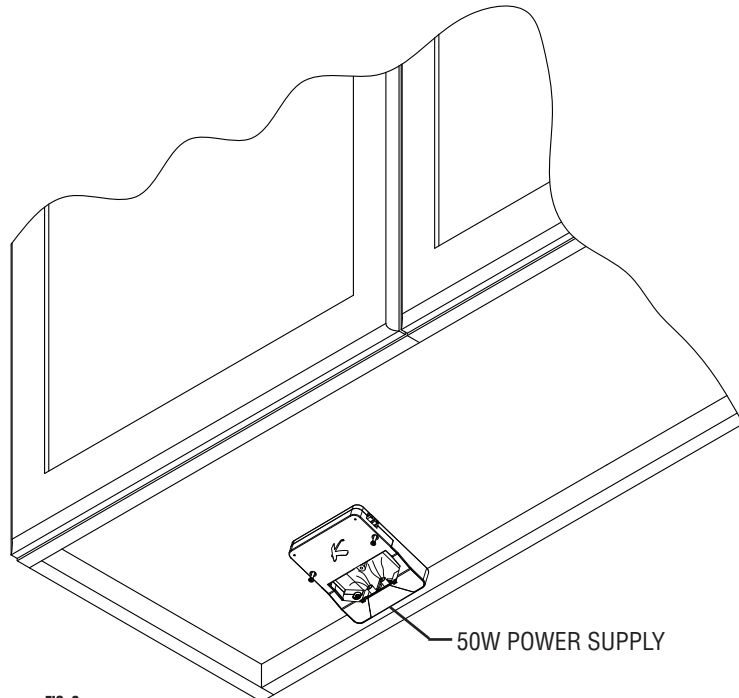

FIG. 3

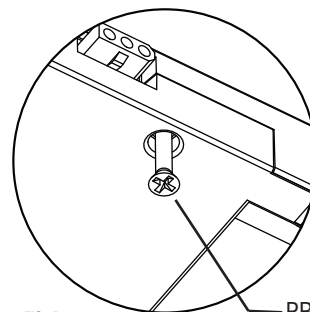

FIG. 4

PRE-INSTALLED SCREW

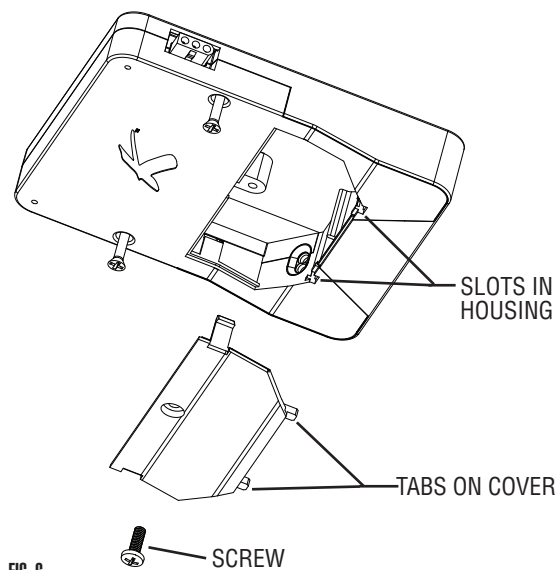

FIG. 6