

TYPE CSWN

Features

- Manufactured from high strength seamless copper tubing
- Electro-Tin plated
- Narrow tang width
- Chamfered entry
- Color coded
- Suitable for use in circuits rated 35KV or less, proper high voltage spacing and insulation techniques must be used
- UL Listed and CSA Certified with ILSCO and major competitor's compression tools
- UL467 Listed 500 kcmil - 8 AWG , #8 - #2 SOL
- Rated to 90° C

Benefits

- Offers maximum conductivity and excellent crimping characteristics
- Provides low contact resistance
- For limited space applications
- For easy conductor insertion
- Identifies the proper compression die
- Application versatility
- Reduces inventory requirements
- For grounding and bonding applications

A

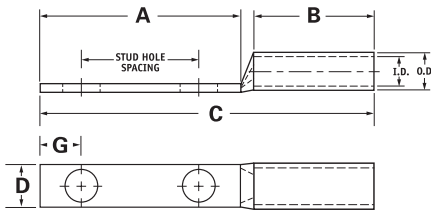

Catalog Number	Wire Size	Alt Wire Size	Expanded* Wire Range	Bolt Size	Stud Hole Dia.	Stud Hole Spacing	Dimensions					Die Color Code	Die Index	O.D.	I.D.
							A	B	C	D	G				
CSWN-2-14	#2 AWG	#2 SOL	2-6 AWG	1/4	0.281	-	0.875	0.625	1.786	0.406	0.320	Brown	I-33	0.421	0.312
CSWN-2-14-58	#2 AWG	#2 SOL	2-6 AWG	1/4	0.281	0.625	1.437	0.625	2.348	0.406	0.320	Brown	I-33	0.421	0.312
CSWN-1-14	#1 AWG	#2 FLEX	1-6 AWG	1/4	0.281	-	0.875	0.625	1.830	0.453	0.320	Green	I-37	0.468	0.359
CSWN-1/0-516	1/0 AWG	#1 FLEX	1/0-6 AWG	5/16	0.343	-	0.875	0.750	1.981	0.500	0.352	Pink	I-42	0.515	0.390
CSWN-2/0-516	2/0 AWG	1/0 FLEX	2/0-4 AWG	5/16	0.343	-	0.875	0.750	2.021	0.547	0.352	Black	I-45	0.562	0.437
CSWN-3/0-38	3/0 AWG	2/0 FLEX	3/0-2 AWG	3/8	0.406	-	0.875	0.750	2.064	0.594	0.414	Orange	I-50	0.609	0.484
CSWN-4/0-38	4/0 AWG	3/0 FLEX	4/0-1 AWG	3/8	0.406	-	0.875	0.875	2.241	0.672	0.414	Purple	I-54	0.687	0.546
CSWN-250-38-1	250kcmil	4/0 FLEX	250kcmil - 1/0 AWG	3/8	0.406	-	1.937	1.063	3.531	0.735	0.414	Yellow	I-62	0.750	0.593
CSWN-350-38	350kcmil	250 I,K,M FLEX 262.2 DLO	350kcmil - 3/0 AWG	3/8	0.406	-	0.875	1.063	2.561	0.875	0.414	Red	I-71	1.250	0.991
CSWN-350-38-1	350kcmil	250 I,K,M FLEX 262.2 DLO	350kcmil - 3/0 AWG	3/8	0.406	1.000	1.937	1.063	3.623	0.875	0.414	Red	I-71	1.250	0.991
CSWN-500-38	500kcmil	350 G,H,I,K,M FLEX 373.7 DLO	500kcmil - 250kcmil	3/8	0.406	-	0.875	1.300	2.907	1.047	0.414	Brown	I-87	1.250	0.991
CSWN-600-38	600kcmil	400 G,H,I,K,M FLEX 444.4 DLO	600kcmil - 250kcmil	3/8	0.406	-	0.875	1.375	3.059	1.172	0.414	Green	I-94	1.250	0.991
CSWN-750-38-1	750kcmil	600 G,H,I,K,M FLEX 646.4 DLO	750kcmil - 500kcmil	3/8	0.406	1.000	1.937	1.500	4.339	1.298	0.414	Black	I-106	1.250	0.991
CSWN-1000-38-1	1000kcmil	750 G,H,I FLEX 777.7 DLO	1000kcmil - 750kcmil	3/8	0.406	1.000	1.937	1.625	4.587	1.485	0.414	White	I-125	1.250	0.991
CSWN-1000-12-134	1000kcmil	750 G,H,I FLEX 777.7 DLO	1000kcmil - 750kcmil	1/2	0.562	1.750	3.000	1.625	5.650	1.485	0.546	White	I-125	1.250	0.991

All wire sizes, unless noted otherwise, are American Wire Gauge (AWG)

* When installed with specified dieless tools

See pages 98 to 103 for complete tooling information.

UL File E6207