

**A**  
**TYPE**  
**CLNU**

**Features**

- Manufactured from high strength seamless copper tubing
- Electro-Tin plated
- Chamfered entry
- Color coded
- Suitable for use in circuits rated 35KV or less, proper high voltage spacing and insulation techniques must be used
- UL Listed and CSA Certified with ILSCO and major competitor's compression tools
- UL467 Listed 500 kcmil - 8 AWG , #8 - #2 SOL
- Rated to 90° C

**Benefits**

- Offers maximum conductivity and excellent crimping characteristics
- Provides low contact resistance
- For easy conductor insertion
- Identifies the proper compression die
- Application versatility
- Reduces inventory requirements
- For grounding and bonding applications

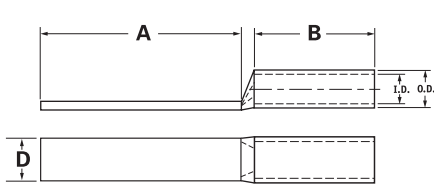

Catalog Number	Wire Size	Alt Wire Size	Expanded* Wire Range	Dimensions			Die Color Code	Die Index	O.D.	I.D.
				A	B	D				
CLNU-6	6 AWG	#6 FLEX, #6 SOL	-	3.000	1.130	0.760	Blue	I-24	0.320	0.225
CLNU-4	4 AWG	#4 SOL	4-6 AWG	3.000	1.130	0.760	White	I-29	0.343	0.250
CLNU-3	3 AWG	#4 FLEX	3-6 AWG	3.000	1.130	0.750	White	I-29	0.375	0.275
CLNU-2	2 AWG	#2 SOL	2-6 AWG	3.000	1.130	0.740	Brown	I-33	0.421	0.312
CLNU-1	1 AWG	#2 FLEX	1-6 AWG	3.000	1.380	0.740	Green	I-37	0.468	0.359
CLNU-1/0	1/0 AWG	#1 FLEX	1/0-6 AWG	3.000	1.500	0.740	Pink	I-42	0.515	0.390
CLNU-2/0	2/0 AWG	1/0 FLEX	2/0-4 AWG	3.000	1.500	0.810	Black	I-45	0.562	0.437
CLNU-3/0	3/0 AWG	2/0 FLEX	3/0-2 AWG	3.000	1.500	0.890	Orange	I-50	0.609	0.484
CLNU-4/0	4/0 AWG	3/0 FLEX	4/0-1 AWG	3.000	1.500	1.000	Purple	I-54	0.687	0.546
CLNU-250	250kcmil	4/0 FLEX	250kcmil-1/0 AWG	3.000	1.690	1.090	Yellow	I-62	0.750	0.593
CLNU-300	300kcmil	250 G,H FLEX	300kcmil-2/0 AWG	3.000	2.000	1.190	White	I-66	0.812	0.660
CLNU-350	350kcmil	250 I,K,M FLEX 262.2 DLO	350kcmil-3/0 AWG	3.000	2.000	1.290	Red	I-71	0.890	0.703
CLNU-400	400kcmil	300 G,H,I,K,M FLEX 313.1 DLO	400kcmil-4/0 AWG	3.000	2.130	1.370	Blue	I-76	0.937	0.750
CLNU-500	500kcmil	350 G,H,I,K,M FLEX 373.7 DLO	500kcmil-250kcmil	3.000	2.250	1.530	Brown	I-87	1.062	0.828
CLNU-600	600kcmil	400 G,H,I,K,M FLEX 444.4 DLO	600kcmil-250kcmil	3.000	2.690	1.710	Green	I-94	1.187	0.920
CLNU-650	650kcmil	500 G,H,I,K,M FLEX 535.3 DLO	650kcmil-350kcmil	3.000	2.690	1.760	Pink	I-99	1.217	0.958
CLNU-700	700kcmil	500 G,H,I,K,M FLEX 535.3 DLO	700kcmil-350kcmil	3.000	2.690	1.820	Pink	I-99	1.250	0.991
CLNU-750	750kcmil	600 G,H,I,M FLEX 646.4 DLO	750kcmil-500kcmil	3.000	2.880	1.900	Black	I-106	1.313	1.031
CLNU-1000	1000kcmil	750 G,H,I FLEX 777.7 DLO	1000kcmil-750kcmil	3.000	3.000	2.170	White	I-125	1.500	1.172

All wire sizes, unless noted otherwise, are American Wire Gauge (AWG)

\* When installed with specified dieless tools

See pages 98 to 103 for complete tooling information.

For Bent Tangs add "-4" for 45 deg. or "-9" for 90 deg.

UL File E6207