

TYPE BGRC

Features

- Manufactured from cast bronze
- Supplied with silicone bronze hardware
- UL 467 Listed for direct burial and CSA Certified

Benefits

- Ensures maximum strength and durability
- Suitable for direct burial in earth or concrete
- Ensures a safe and reliable grounding connection

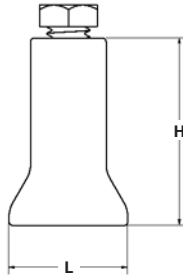
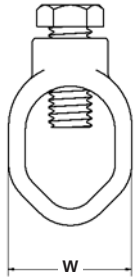

Catalog Number	Ground Rod		Rebar		Dimensions - in. (mm)		
	Size	Wire Range	Size	Wire Range	W	H	L
BGRC-48	1/2	2-10	-	-	0.892 (22.7)	1.270 (32.3)	0.822 (26.2)
BGRC-58	5/8	1/0-8	#5	1/0-8	1.031 (26.2)	1.428 (36.3)	0.925 (23.5)
BGRC-68	3/4	1/0-8	-	-	1.031 (26.2)	1.550 (39.4)	1.040 (27.2)

All wire sizes, unless noted otherwise, are American Wire Gauge (AWG)
Tested to UL 467, UL File E34440

TYPE BGRC

Features

- Manufactured from cast bronze
- Supplied with silicone bronze hardware
- UL 467 Listed for direct burial and CSA Certified

Benefits

- Ensures maximum strength and durability
- Suitable for direct burial in earth or concrete
- Ensures a safe and reliable grounding connection

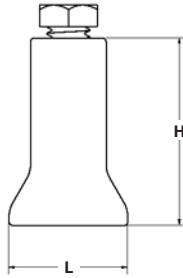
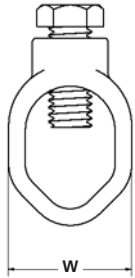

Catalog Number	Ground Rod		Rebar		Dimensions - in. (mm)		
	Size	Wire Range	Size	Wire Range	W	H	L
BGRC-48	1/2	2-10	-	-	0.892 (22.7)	1.270 (32.3)	0.822 (26.2)
BGRC-58	5/8	1/0-8	#5	1/0-8	1.031 (26.2)	1.428 (36.3)	0.925 (23.5)
BGRC-68	3/4	1/0-8	-	-	1.031 (26.2)	1.550 (39.4)	1.040 (27.2)

All wire sizes, unless noted otherwise, are American Wire Gauge (AWG)
Tested to UL 467, UL File E34440

TYPE BGRC

Features

- Manufactured from cast bronze
- Supplied with silicone bronze hardware
- UL 467 Listed for direct burial and CSA Certified

Benefits

- Ensures maximum strength and durability
- Suitable for direct burial in earth or concrete
- Ensures a safe and reliable grounding connection

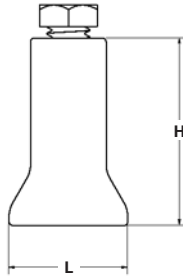
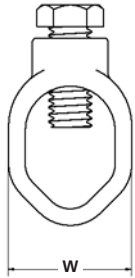

Catalog Number	Ground Rod		Rebar		Dimensions - in. (mm)		
	Size	Wire Range	Size	Wire Range	W	H	L
BGRC-48	1/2	2-10	-	-	0.892 (22.7)	1.270 (32.3)	0.822 (26.2)
BGRC-58	5/8	1/0-8	#5	1/0-8	1.031 (26.2)	1.428 (36.3)	0.925 (23.5)
BGRC-68	3/4	1/0-8	-	-	1.031 (26.2)	1.550 (39.4)	1.040 (27.2)

All wire sizes, unless noted otherwise, are American Wire Gauge (AWG)
Tested to UL 467, UL File E34440