

**P4R & RR4 Remodel Housing  
For NON-Insulated Ceiling Use**

Part No. 7-15465-101

**INSTALLATION INSTRUCTIONS**

**WARNING: FIRE HAZARD/ELECTRICAL HAZARD**

This equipment is intended to be installed by qualified personnel. The installation must be in accordance with the current edition of the National Electrical Code, and all applicable state and local building codes. The final installation must be approved by the appropriate, qualified electrical/building inspector(s). Improper installation may result in a fire or electrical hazard.

**Comply with all building codes!**

Prior to installation, make certain using the proper lamp type and wattage bulb.

**Read all instructions before installing housing.**

Retain for future reference.

**WARNING- NOT FOR USE IN INSULATED CEILINGS**

**Detailed Instructions for Installing recessed remodel housing in a non-insulated ceiling**

1. Mark desired location (center) of housing.
- 2a. If using hole saw, carefully drill hole in ceiling.
- 2b. Otherwise, use the template furnished and scribe circle in desired location. Carefully cut hole in ceiling with keyhole saw.
3. Provide electrical service according to your electrical code from a suitable junction box to the wiring box. Supply wire insulation must be rated for at least 90°C.
4. Remove junction box door on housing.
5. Remove knockouts as required and secure Romex or conduit to junction box.
6. Connect fixture leads and ground wire to electrical supply with proper size wire nuts (not included). Connect white to white, black to black, and green to bare copper wire (in wiring box). Ground wire at the service junction box may need to be secured to a ground screw.
7. Place all wiring and connections in junction box on housing and replace junction box door.
8. **FIXTURES ARE NON IC RATED. DO NOT COVER WITH THERMAL INSULATION.**  
Thermal insulation shall not be installed above a recessed fixture or within 3" of the recessed fixture's enclosure, wiring compartment, or ballast unless it is identified for contact with insulation, Type IC. [NEC, 410-66(b)]
9. **Before inserting housing into ceiling, check that spring clips are fully recessed inside of housing.**
10. Insert fixture into ceiling with junction box end going first.
11. Line up fixture aperture with ceiling cutout and hold housing flush against ceiling. Reach inside of housing and push spring clip outward until ceiling is firmly clamped between housing and clip. Repeat with other clips.

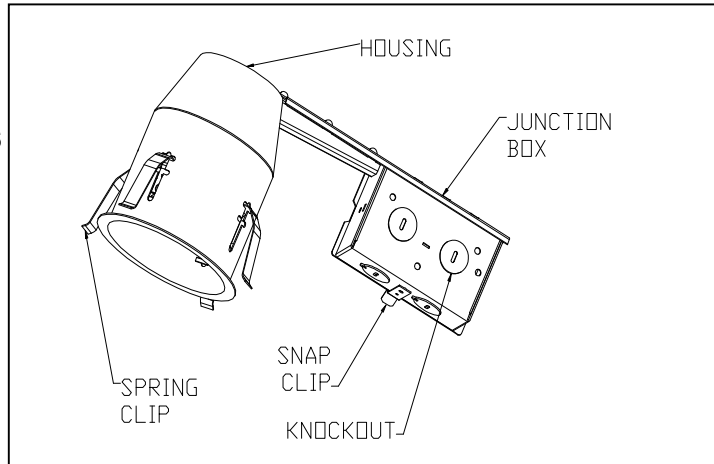

**NOTE: Insert installation instruction sheet into aperture in housing to prevent contamination of fixture during ceiling finishing. Remove instruction sheet prior to installation of finishing trim.**

**capri**  
L I G H T I N G  
[www.caprilighting.com](http://www.caprilighting.com)

Capri Omega  
776 South Green St  
Tupelo, MS 38802  
662-842-7212  
662-841-5501 fax

Canadian Division  
189 Bullock Drive  
Markham, Ontario L3P 1W4  
905-294-9570  
905-294-9811 fax