

# Thin Wall Conduit Fittings (for EMT Conduit)

Push-in EMT Raintight Fittings – Zinc Die Cast

EMT Fittings

## PUSH-IN EMT RAINLIGHT FITTINGS – ZINC DIE CAST

### Applications:

- Used to join EMT conduit to a box or enclosure in raintight environments
- Design prevents water seepage into conduit, box or enclosure

### Features:

- Fast installation; fittings push onto the EMT conduit without the use of any tools or additional labor
- No disassembly required
- Available in 1/2" and 3/4" trade sizes for both connectors and couplings
- Available in insulated and non-insulated versions to meet customer preference
- Raintight listed
- Concrete tight
- Patented design

### Certifications and Compliances:

- UL and cUL Listed, File No. E-22132

### Standard Materials and Finishes:

- Body – zinc die cast, natural
- Gasket – neoprene

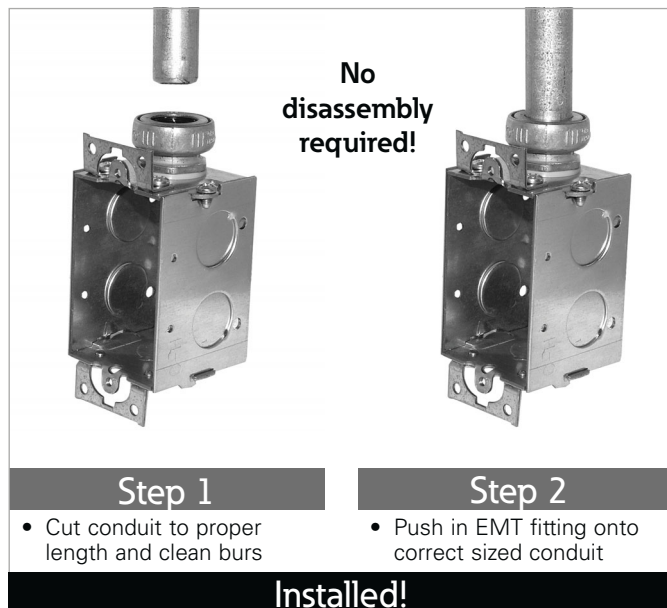

### Straight Connectors – Non-insulated

UL File No. E-22132



Cat. #	Size	Unit Qty.	Wt. Lbs. Per 100
650RTQ	1/2"	50	10.1
651RTQ	3/4"	25	13.4

### Straight Connectors – Insulated

UL File No. E-22132



Cat. #	Size	Unit Qty.	Wt. Lbs. Per 100
1650RTQ	1/2"	50	10.1
1651RTQ	3/4"	25	13.4

### Couplings

UL File No. E-22132



Cat. #	Size	Unit Qty.	Wt. Lbs. Per 100
660RTQ	1/2"	50	13.1
661RTQ	3/4"	25	16.9