

Compression Connections

BURNDY®

Copper Compression – Code – Long Barrel – Inspection Window

C-28

ONE HOLE HYLUG™ CODE CONDUCTOR LONG BARREL WITH INSPECTION WINDOW (Continued)

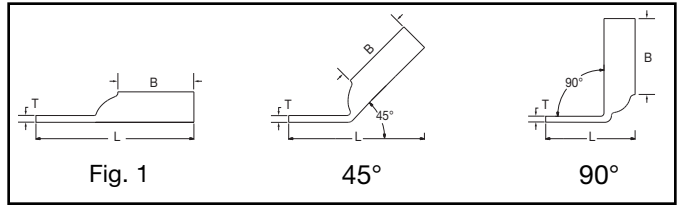

UL Listed 90° C,
600 Volts to 35 kV ◆

45° and 90° angles are available.
Please contact Customer Service to order:
1-800-346-4175



Catalog Number	Fig #	Conductor		Stud Hole Size	Tongue Width	Figure Dimensions			Dieless (# of crimps)	▲ Installation Tooling				Wire Strip Length	
		AWG	MM²			(B)	(T)	(L)		Mechanical MD6, OUR840, MD7-34R	Hydraulic		Color Code		Die Index
											BCT500HS, Y500CTHS	Y35, Y39, Y750, Y46*, PAT750			
YAZ3CTC14	1	#3 AWG #2 Sol	25	1/4"	.55"	1.25"	.09"	2.21"	Y1MRTC (4) MY29-3 (2) MY29-11 (2) MRC840 (2) Y644HS (1) Y81KFT (2) Y81KFTMBH (2) PAT81KFT-18V (2)	W3CRT (2)	W3CRT (2)	U3CRT (2)	White	9	1-5/16"
YAZ3CTC38	1			3/8"	.58"	1.25"	.08"	2.39"							
YAZ3CTC12	1			1/2"	.83"	1.25"	.07"	2.83"							
YAZ2CTC14	1	#2 AWG	35	1/4"	.60"	1.25"	.11"	2.23"	W2CVT (2) W2CRT (2) X2CRT (2)	W2CVT (2) W2CRT (2) X2CRT (2)	U2CRT (2)	Brown	10	1-5/16"	
YAZ2CTC38	1			3/8"	.60"	1.25"	.11"	2.41"							
YAZ2CTC12	1			1/2"	.83"	1.25"	.09"	2.85"							
YAZ1CTC14	1	#1 AWG	50	1/4"	.67"	1.38"	.10"	2.39"	W1CVT (2) W1CRT-1 (2) X1CRT-1 (2)	W1CVT (2) W1CRT-1 (2) X1CRT-1 (2)	U1CRT-1 (2) U4CABT (2)	Green	11 or 375	1-7/16"	
YAZ1CTC38	1			3/8"	.67"	1.38"	.10"	2.57"							
YAZ1CTC12	1			1/2"	.83"	1.38"	.09"	3.01"							
YAZ25TC14	1	1/0 AWG	—	1/4"	.75"	1.38"	.12"	2.42"	MY29-3 (2) MY29-11 (2) MRC840 (4) Y644HS (1) Y81KFT (2) Y81KFTMBH (2) PAT81KFT-18V (2)	W25VT (4) W25RT (4) X25RT (4)	W25VT (4) W25RT (4) X25RT (4)	U25RT (2) U2CABT (2)	Pink	12 or 348	1-7/16"
YAZ25TC516	1			5/16"	.75"	1.38"	.12"	2.47"							
YAZ25TC38	1			3/8"	.75"	1.38"	.12"	2.60"							
YAZ25TC12	1			1/2"	.83"	1.38"	.12"	3.04"							
YAZ26TC14	1	2/0 AWG	70	1/4"	.83"	1.50"	.12"	2.58"	W26VT (4) W26RT (4) X26RT (4)	W26VT (4) W26RT (4) X26RT (4)	U26RT (2)	Black	13	1-9/16"	
YAZ26TC38	1			3/8"	.83"	1.50"	.12"	2.76"							
YAZ26TC12	1			1/2"	.83"	1.50"	.12"	3.2"							
YAZ27TC38	1	3/0 AWG	—	3/8"	.90"	1.50"	.12"	2.8"	W27RT (4) W27VT (4) X27RT (6)	W27RT (4) W27VT (4) X27RT (6)	U27RT (2)	Orange	14	1-9/16"	
YAZ27TC12	1	3/0 AWG	—	1/2"	.91"	1.5"	0.12"	3.23"	W27RT (4) W27VT (4) X27RT (6)	W27RT (4) W27VT (4) X27RT (6)	U27RT (2)	Orange	14	1-9/16"	
YAZ28TC38	1	4/0 AWG	—	3/8"	1.02"	1.62"	0.14"	2.99"	Y644HS (1) Y81KFT (2) Y81KFTMBH (2) PAT81KFT-18V (2)	W28VT (4) W28RT (4) X28RT (6)	W28VT (4) W28RT (4) X28RT (6)	U28RT (2)	Purple	15	1-11/16"
YAZ28TC12	1			1/2"	1.02"	1.62"	0.14"	3.40"							
YAZ29TC38	1	250 kcmil	—	3/8"	1.10"	1.62"	0.16"	2.99"	MY29-3 (2) MY29-11 (2) Y644HS (1) Y81KFT (2) Y81KFTMBH (2) PAT81KFT-18V (2)	W29VT (4) X29RT (8)	W29VT (4) W29RT (4) X29RT (6)	U29RT (2)	Yellow	16	1-11/16"
YAZ29TC12	1			1/2"	1.10"	1.62"	0.16"	3.43"							

* Use PUADP-1 adapter with U dies in Y46 HYPRESS™.
** P-RT die sets for use in Y46 HYPRESS™ only, PUADP-1 adapter not required.

*** The MM² conductor sizes listed are the recommendations for Class 2 conductor.
▲ See tooling section of this catalog for complete tool and die listings.

• Available undrilled. Add suffix U to catalog number (example: YA25U).
◆ For applications greater than 2000 Volts consult cable manufacturer for voltage stress relief instructions.
Note: All dimensions shown are for reference only.

Blue highlighted items are industry standard and most frequently ordered.