



Bridgeport Fittings Inc.

705 Lordship Blvd.
Stratford, CT 06615

Phone: 203-377-5944

Fax: 203-381-3488

Malleable with/without Cover & Gasket

Images

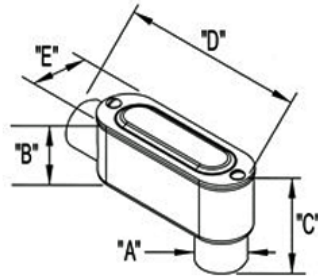

[Download Photo Image](#)

[Download Dimensional Image](#)

Dimension A in Inches: 1.66

Dimension B in Inches: 2.25

Dimension C in Inches: 3.18

Dimension D in Inches: 6.28

Dimension E in Inches: 1.82

Application

For use with 1" rigid metallic raceways. Allows access to conductors for pulling and splicing. Suitable for use in Wet Locations. Nema 4 rated. Includes stamped steel cover and neoprene gasket. 12.5 cubic inch volume. Max conductor fill is 3-#4AWG

Product Information

Material: Malleable Iron Conduit Body, Zinc
Coated Steel Cover, Neoprene Gasket
Finish: Zinc Plated Aluminum Enameled

Certifications & Codes:

Federal Specification Number: A-A-50563A

NEMA Standard: FB-1

UL File Number: E11077

UL Standard: UL514B

UNSPSC: 39131708

Catalog ID: LB-63CG

UPC Number: 78174706173

Description: 1 inch malleable iron LB conduit body with steel cover and neoprene gasket. Constructed with NPT "tapered" hubs.

Application: For use with 1" rigid metallic raceways. Allows access to conductors for pulling and splicing. Suitable for use in Wet Locations. Nema 4 rated. Includes stamped steel cover and neoprene gasket. 12.5 cubic inch volume. Max conductor fill is 3-#4AWG

Trade Size: 1"

Std Pkg Qty: 20

Unit Qty: 2