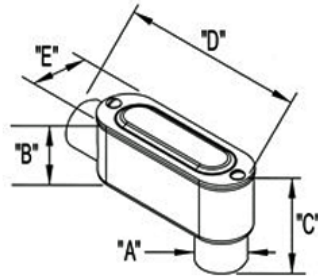

Malleable with/without Cover & Gasket

Images

[Download Photo Image](#)[Download Dimensional Image](#)

Dimension A in Inches: 1.33
Dimension B in Inches: 1.94
Dimension C in Inches: 2.68
Dimension D in Inches: 5.44
Dimension E in Inches: 1.62

Application

For use with 3/4" rigid metallic raceways. Allows access to conductors for pulling and splicing. Suitable for use in Wet Locations. Nema 4 rated. Includes stamped steel cover and neoprene gasket. 7.5 cubic inch volume. Max conductor fill is 3-#6AWG

Product Information

Material: Malleable Iron Conduit Body, Zinc Coated Steel Cover, Neoprene Gasket
Finish: Zinc Plated Aluminum Enameled

Certifications & Codes:

Federal Specification Number: A-A-50563A
NEMA Standard: FB-1
UL File Number: E11077
UL Standard: UL514B
UNSPSC: 39131708

Catalog ID: LB-62CG

UPC Number: 78174706172

Description: 3/4 inch malleable iron LB conduit body with steel cover and neoprene gasket. Constructed with NPT "tapered" hubs.

Application: For use with 3/4" rigid metallic raceways. Allows access to conductors for pulling and splicing. Suitable for use in Wet Locations. Nema 4 rated. Includes stamped steel cover and neoprene gasket. 7.5 cubic inch volume. Max conductor fill is 3-#6AWG

Trade Size: 3/4"

Std Pkg Qty: 50

Unit Qty: 5